

OREGON PUBLIC LAND CORNER REPORT / RESTORATION REPORT
Tillamook County Surveyor's Office

BOOK 8 216

SECTION: 21	TOWNSHIP: 1 South	RANGE: 10 West
COUNTY: Tillamook		DATE: 1/9/2025
CORNER DESIGNATION:		(Please check one)
The West 1/16 th corner common to Sections 21 and 28, Township 1 South, Range 10 West, Willamette Meridian; Tillamook County, Oregon.		<input checked="" type="checkbox"/> Condition Report Only
		<input type="checkbox"/> Restoration
		<input type="checkbox"/> Rewitness
		<input type="checkbox"/> Unrecorded
		<input type="checkbox"/> Reset at surface
		<input type="checkbox"/> Referenced Out

Previous Rewitnesses, Restorations and Surveys, etc...
Map B-3635 (2014)

History, condition, and sources

In 2014 (Map B-3635) Terry Jones PLS 2507 Set a 1" galvanized iron pipe with a 2 1/2" brass cap stamped "W 1/16 S21 S28 LS 2507 2011" as shown hereon and established accessories. In 2025 (Field Book MR 17 pg. 29-32 1/2025) the Tillamook County Surveyors Office Found a 2 1/2" brass cap stamp as shown hereon to be in good condition. The accessories are listed here below.

Found: (Map B-3635) 4"x4" post North 2.0'

Found: (Map B-3635) 1/2" fiberglass post East 2.0'

Found: (Map B-3635) 3" dia. spruce scribed "S28 BT" with brass nail and washer stamped "LS 2507" S13°W 7.74' now 12" dia. with healed scar and metal location tag.

Found: (Map B-3635) 5/8" x 30" rebar with yellow plastic cap stamped "Terry Jones LS 2507" N87°57'44"W 118.47' Now 0.2' below surface in good condition.

New accessories set:

The monument was conventionally tied using GPS established control in Oregon North Zone NAD 83/91 grid coordinates in US Survey feet. Coordinates provided hereon are given in WGS 84 Latitude and Longitude.

Latitude: 45°27'49.76940"

Longitude: -123°55'20.04917"

Pictures of Found Monuments:



Location: ± 100' East of logging road #725.

Tillamook County Surveyor office: 1510 3rd Street Suite C, Tillamook, OR. 97141

Party Chief: Travis Porter, Tillamook County Surveyors Office

Witnesses: Michael Rice P.L.S. 86926, Tillamook County Surveyor
Kael Poklikuha, Tillamook County Survey Technician

Notes: Digital images taken of monument and accessories.

SURVEYOR'S SEAL



RENEWAL 12-31-2026

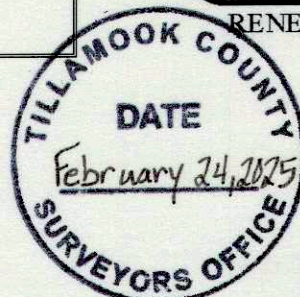

BOOK 8 216