

SURVEYORS CERTIFICATE

I, W. E. Anderson, County Surveyor of Tillamook Co., Ore do hereby certify that this map was made from notes taken during an actual survey made by me in Dec 1929 and that it correctly represents the property and Bids herein shown
 W. E. Anderson

BAY AVE

UNIMPROVED

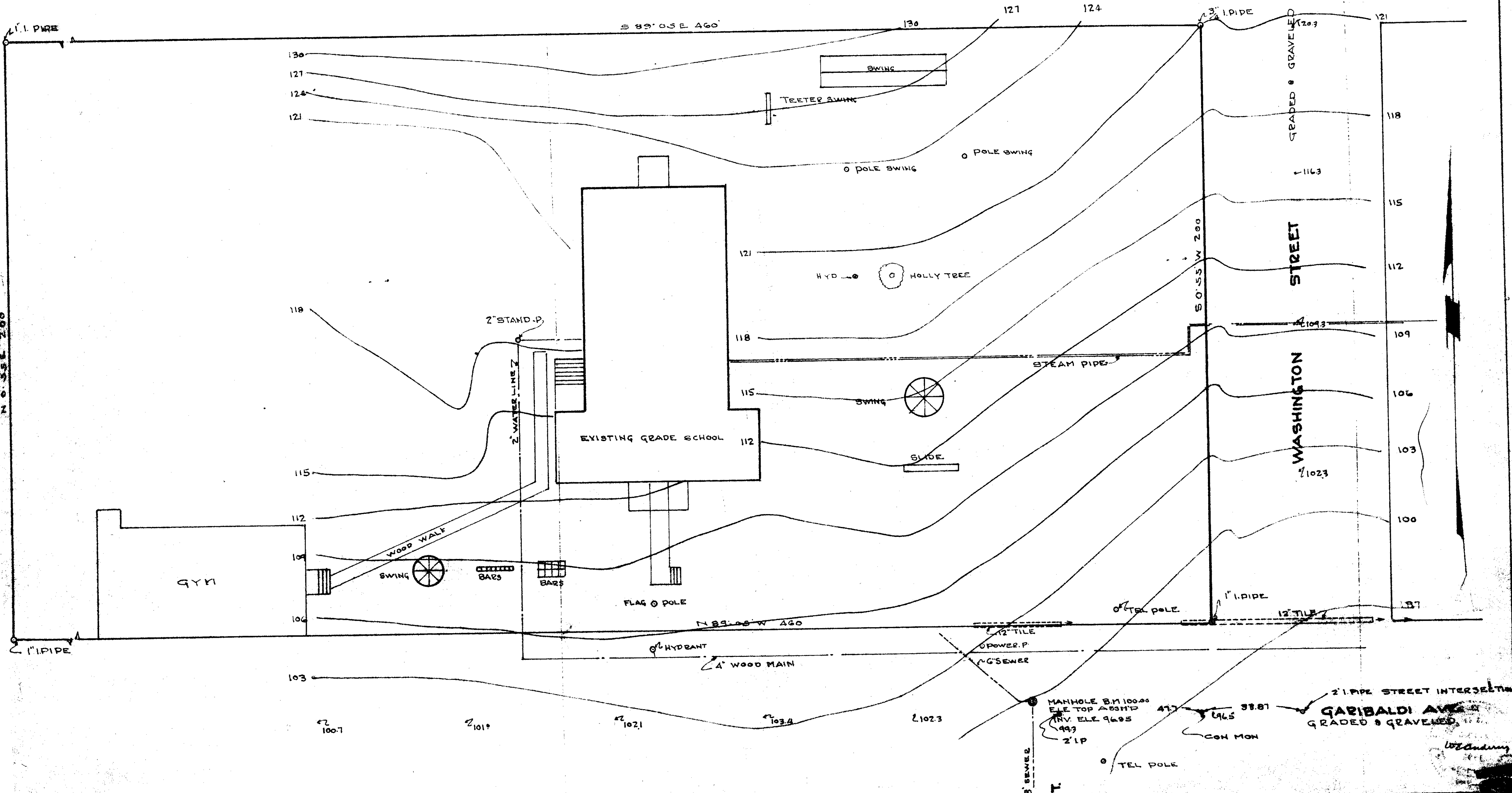

VICINITY MAP
 SHOWING
GABIBALDI GRADE SCHOOL GROUNDS
 LOCATED IN SW 1/4 GABIBALDI PARK
 TILLAMOOK CO. ORE
 SCALE 1" = 20' W. ANDERSON.
 21-11-10.

F 40-50