

MAP
OF
COUNTY ROAD
FROM
NEHALEM TO MOHLER
IN
SECS. 26, 27 AND 35 TR. 3N. R. 10W. W.M.
TILLAMOOK COUNTY
JAN. 1912 U.G. Jackson, Co. Sur.
SCALE: 300'=1"

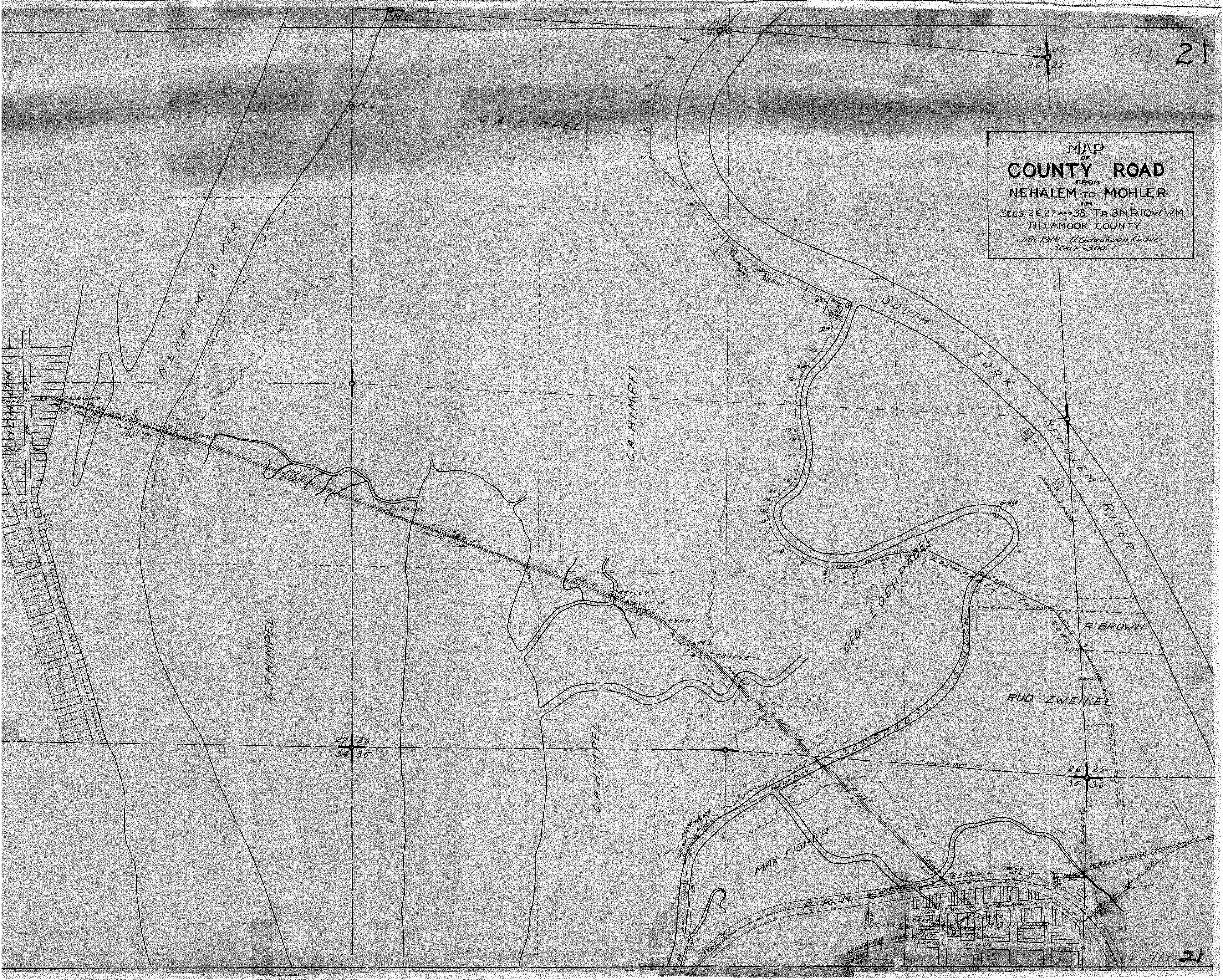

27 26
34 35

26 25
35 36